

Guardus® overtube

quick reference guide

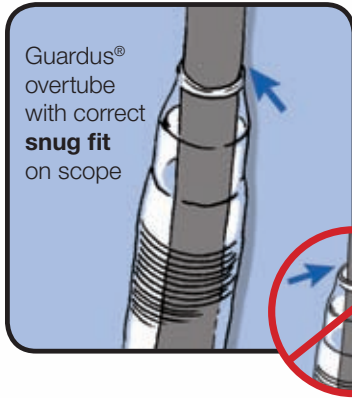

Figure 1

Select the correct Guardus® overtube based on endoscope's size. See scope reference chart in product packaging.

Guardus® overtube with incorrect, **loose fit** between the inner tube and the scope.

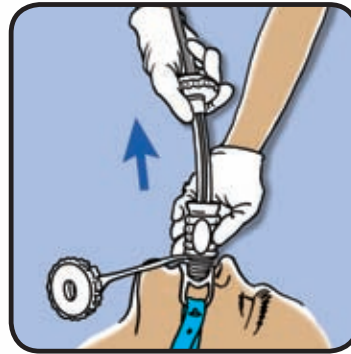

Figure 4

After performing baseline EGD, insert the overtube assembly through the bite block and slide the overtube assembly to the desired anatomical location. **Remove the inner tube and scope simultaneously**, holding the outer tube in place.

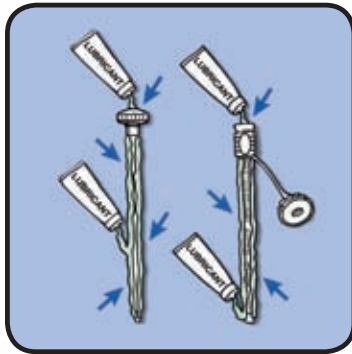

Figure 2

Lubricate, Lubricate, Lubricate.

Use a water-soluble lubricant. Generously lubricate the *inner* and *outer* surfaces of *both* tubes. **Do not use water.**

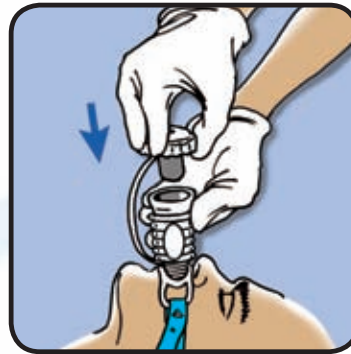

Figure 5

Attach the insufflation cap. The insufflation cap minimizes backflow of body fluids, and maintains insufflation throughout procedure.

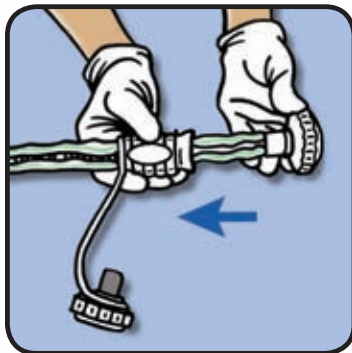

Figure 3

Assemble Guardus® overtube.

Insert the *fully lubricated* inner tube into the *fully lubricated* outer tube and "backload," positioning the assembled Guardus® overtube at the proximal end of the scope.

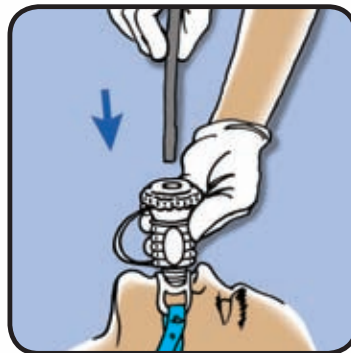

Figure 6

Reintroduce the endoscope through the insufflation cap and perform the intended procedure.

notes:

- Refer to the current **Instructions For Use** for complete product usage instructions
- **NEVER FORCE** the Guardus® overtube into place
- When repositioning or advancing the overtube, refer to the **Instructions For Use**
- A 60FR bite block is required to accommodate the size of the Guardus® overtube



listening...and delivering solutions®

5976 Heisley Road
Mentor OH 44060

phone 440 / 639.4494

fax 440 / 639.4495

customer service 800 / 769.8226

www.usendoscopy.com

760442 Rev. A